

CENTRAL BEDFORDSHIRE COUNCIL (BEDFORDSHIRE COUNTY COUNCIL  
(DISTRICT OF MID BEDFORDSHIRE) (CIVIL ENFORCEMENT AREA AND SPECIAL  
ENFORCEMENT AREA) (WAITING RESTRICTIONS AND STREET PARKING PLACES)  
(CONSOLIDATION) ORDER 2008) (VARIATION NO.46) ORDER 2016

The Central Bedfordshire Council (the "Council") in exercise of its powers under sections 1(1), 2(1) to (3), 4 (2) and Part IV of Schedule 9 of the Road Traffic Regulation Act 1984 ("The Act") and all other enabling powers and after consultation with the Chief Officer of Police in accordance with Part III of schedule 9 to the Act, hereby makes the following Order:

1. This Order shall come into operation on 15th day of January 2016 and may be cited as "Central Bedfordshire Council (Bedfordshire County Council (District of Mid Bedfordshire) (Civil Enforcement Area and Special Enforcement Area) (Waiting Restrictions and Street Parking Places) (Consolidation) Order 2008) (Variation No.46) Order 2016"
2. As from the date upon which this Order comes into operation, the provisions of the "Bedfordshire County Council (District of Mid Bedfordshire) (Civil Enforcement Area and Special Enforcement Area) (Waiting Restrictions and Street Parking Places) (Consolidation) Order 2008" shall be varied as follows:-

To add No Waiting at any time on the following length of road in Shefford:-

- a) School Lane, both sides, from a point approximately 3 metres south of the front wall of no.89 Ampthill Road extending in a southerly direction to a point approximately 3 metres south of the boundary of no.89 Ampthill Road and no.1 School Lane.
- b) School Lane, east side, from a point approximately 3 metres north of the southern property boundary of no.9 School Lane extending in a southerly direction to the end of the road including both sides of the eastern spur road to the school.
- c) School Lane, west side, from a point in approximately 3 metres north of the southern property boundary of no.9 School Lane extending in a southerly direction to the end of the road.

To add No Waiting Monday to Friday from 8.00am to 9.30am and 3.00pm to 4.30pm on the following length of road in Shefford:-

- a) School Lane, both sides, from a point approximately 3 metres south of the boundary of no.89 Ampthill Road and no.1 School Lane extending in a southerly direction to a point approximately 3 metres north of the southern property boundary of no.9 School Lane.
- b) Ampthill Road, north side, from a point approximately 3 metres east of the boundary of nos.76 and 78 Ampthill Road extending in a westerly direction to a point approximately 3 metres west of the boundary of nos.86 and 88 Ampthill Road.

GIVEN under the Common Seal of the Central Bedfordshire Council  
this 13th day of January 2016

THE COMMON SEAL of THE )  
CENTRAL BEDFORDSHIRE COUNCIL )  
was hereunto affixed in the presence of: )

Signed C. D. Kent .....



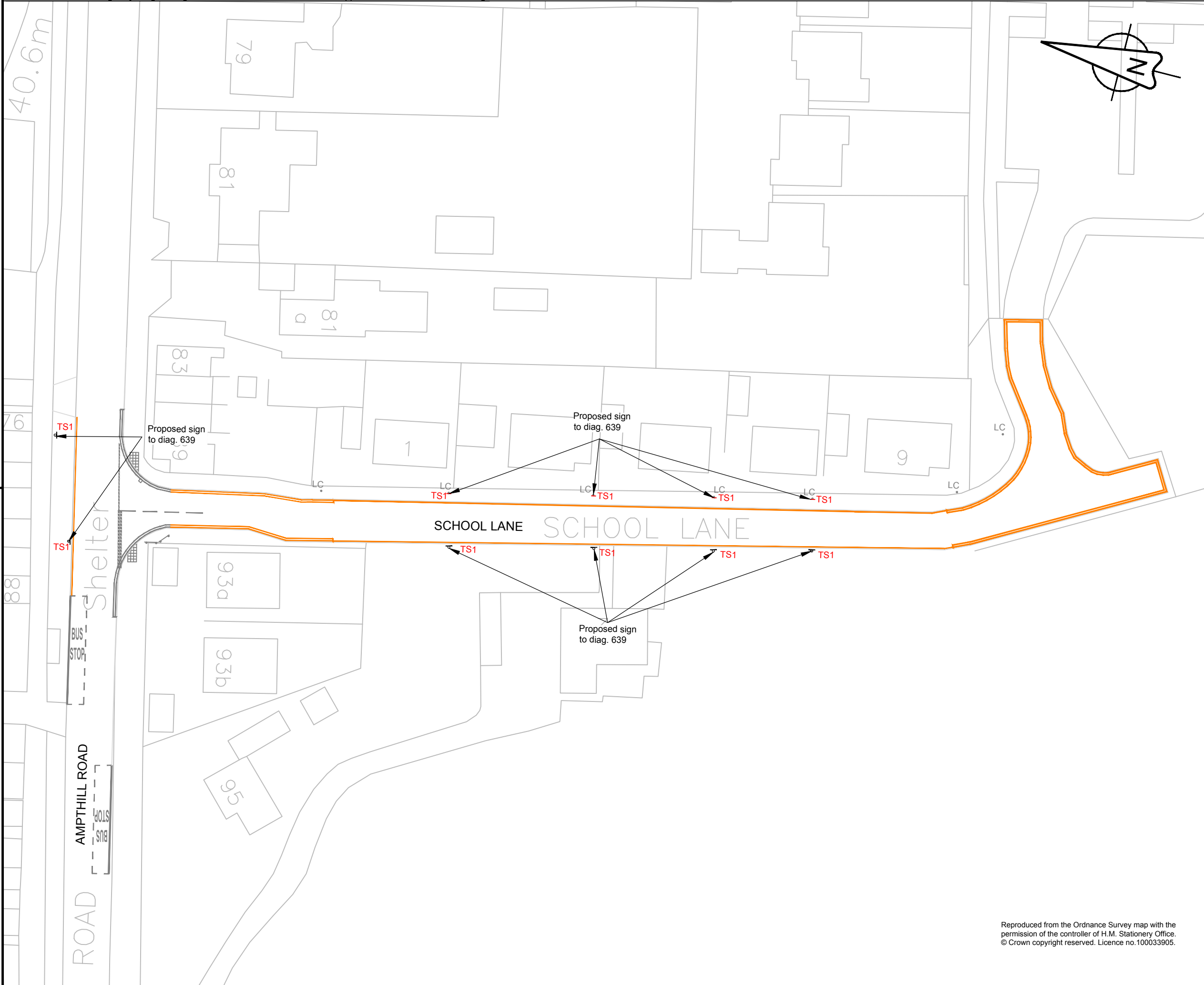

**DESIGN HAZARDS**

(The following information has been collected from Preconstruction Information and the Amey CDM Hazard Management Process.)

1. The site location is close proximity to Street Lighting Column, residential estate, school and junction

- NOTES**
1. Do not scale from this drawing. If in doubt contact engineer on site.
  2. The design & proposals shown are indicative, therefore they are subject to alteration.
  3. All road markings are to Traffic Signs Regulations and General Directions 2002.
  4. Existing road markings coloured grey to remain.

- KEY**
- TS1** Proposed Waiting Restriction Sign (Mon-Fri 8.00-9.30 and 15.00-16.30) erect on existing lamp column.
  - Proposed Double Yellow Road Marking.

Rev	Revision details	Chkd	Appd	Date

Designed: ARH Date: 18/09/2015  
 Drawn: ARH Date: 18/09/2015  
 Checked: DK Date: 18/09/2015  
 Approved: DK Date: 18/09/2015



Project Name  
**Shefford Lower School**

Drawing Title  
**Bedfordshire Highways -  
 Waiting Restriction and  
 Road Markings**

Original Drg Size : A3 Scale : 1:500  
 Dimensions : m

Drawing Status  
**SHARED** Suitability  
**S2**

Drawing No  
**901949-000-001** Revision  
**P2.1**

Reproduced from the Ordnance Survey map with the permission of the controller of H.M. Stationery Office. © Crown copyright reserved. Licence no.100033905.